

## Door Contact (EAS/TFK8)

The Door Contact is used to detect the opening and closing of doors and windows. Typically the Door Contact is fixed to the door frame and the actuating magnet is fixed to the door. When the door opens the magnet is moved away from the Door Contact and an internal magnetic switch is activated causing the Door Contact to transmit an alarm.

The Door Contact can monitor a doorway for open or closed status and notify you of an open door when you wish to arm your system. It can also alert you to signal communication problems and low battery situations.

The Door Contact consists of a two-part design made up of a cover and base. The cover contains all the electronics and the base provides a means of fixing. A PCB tamper switch protects the enclosure from being opened or being removed from the mounting surface.

### ● Identifying the parts

Remove the cover by loosening the bottom fixing screw, the inside of the Door Contact will be revealed as shown.

#### 1 LED indicator

#### 2 Learn / Test button

This button is used for testing the radio performance and for learning purpose.

#### 3 Tamper Switch

The Tamper Switch protects the enclosure from being opened or being removed from the mounting surface.

#### 4 Extension Terminal

In addition to the built-in magnet switch, you can connect an additional "extension magnet switch" or any device with N.C. (Normally Closed) dry contact to this 2-pin terminal for installation convenience.

#### 5 Test / Normal Mode Jumper (JP1)

This jumper is used to put the Door Contact in a Test mode.



If the jumper is ON ( the jumper is inserted connecting the two pins), the Door Contact is in Test mode.



If the jumper is OFF ( if the jumper is removed or "parked" on one pin), the Door Contact is in Normal mode. (Factory Default)

#### 6 Internal Magnet Switch Bypass Jumper Switch (JP2)

This 2-pin jumper switch is to select whether the internal magnet switch is being used.



If the jumper is ON ( the jumper link is inserted connecting the two pins), the internal magnet switch is bypass. Only the device connected to the Extension Terminal will activate the Door Contact.



If the jumper is OFF ( if the jumper link is removed or "parked" on one pin), the internal magnet Switch is in use. (Factory Default)

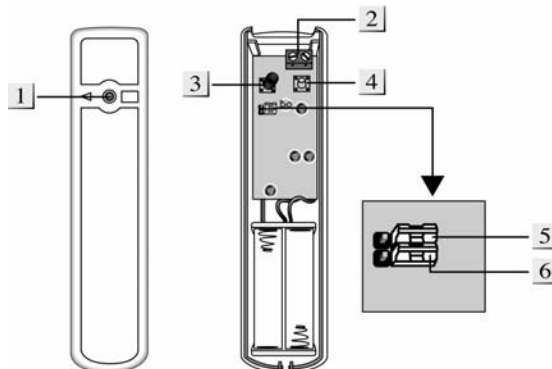

### ● LED Indicator

In Normal operation mode, the LED indicator will not light except in the following situations:

- When the cover is opened and the tamper switch is violated, the LED will light.
- When the Tamper Condition persists or the Door Contact is in Low battery condition, every time the Door Contact is activated, the LED will light.

However, if the Door Contact is in Test mode, the LED will flash every time it is activated.

### ● Battery

The EAS/TFK8 uses two 1.5V "AAA" alkaline batteries with life expectancy at over 2 years at an average of 50 activations a day.

In addition, the Door Contact can detect if the battery is low. If the battery voltage is low, LED will flash accompanied with a Low-volume beep once every 30 sec and inform the Control Panel regularly. Low battery detection operates at a threshold of 2.2V ±10% where the Door Contact has enough reserve power to typically operate for 1 month before complete exhaustion.

### ● Supervisory Signal

- After installation, the Door Contact will automatically transmit Supervisory Signals periodically to the Control Panel at intervals of 30 min. to 50 min. randomly.
- If the Control Panel has not received the signal from the Door Contact for a preset period of time, the Control Panel will indicate it on its display to show that particular Door Contact is experiencing an out-of-signal problem.

### ● Getting Started

- Remove the fixing screw and cover assembly
- Insert the two "AAA" batteries into the battery holder taking care to connect the polarity correctly.
- The LED indicator will flash briefly and please wait for 10 seconds.
- Put the system in Learn mode and learn-in the Door Contact by pressing the learn/Test button. Please refer to section "Add/Delete Device" in the operation manual of the Control Panel.
- After the Door Contact is learnt-in, put the Control Panel into "Walk Test" mode, hold the Door Contact in the desired location, press the Test button to confirm this location is within signal range of the Control Panel.

- When you are satisfied that the Door Contact works in the chosen location, you can proceed with installation.

## ● **Mounting Methods**

There are two ways to mount the Door Contact. By either self adhesive installation or screw mounting

### ● **Self adhesive installation**

- I. Clean the surface with a suitable degreaser.
- II. Remove the protective covering from one side of the double sided adhesive pad and firmly apply to the back of the device.
- III. Next remove the other cover and firmly press the item onto the desired location.

#### <NOTE>

- ☞ Do not use the adhesive pad method of installation on a surface with peeling or cracked paint, or on a rough surface.

### ● **Screw Mounting**

The Base has two knockouts, where the plastic is thinner, for mounting purpose. To mount the Door Contact

- I. Remove the cover.
- II. Break through the knockouts on the base.
- III. Using the holes as a template, drill two holes in the surface.
- IV. Insert the wall plugs if fixing into plaster or brick.
- V. Screw the base into the wall plugs.
- VI. Screw the cover back on to its base.

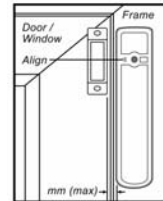

## ● **Installation**

- Step 1 Ensure the Test/Normal mode jumper switch is in "ON" position. This is to enable the LED indicator to flash every time the Door Contact is operated.
- Step 2 Fit the base on the Door frame using either the double sided adhesive pad or the screws provided.
- Step 3 Fit the magnet on the door using the small double sided adhesive pad or the screws provided. Aligning the magnet by the arrow as shown.

#### <NOTE>

- ☞ The magnet should not be more than 30mm from the detector when the door is closed.
  - ☞ Ensure the tamper switch spring is positioned so that it makes contact with the mounting surface through the tamper switch aperture.
  - ☞ Windows can be protected in a similar way to doors. When fitting to a window fix the magnet to the moving part and the door switch to the frame.
- Step 4 Fix the Cover assembly on its base and secure with the screw.
  - Step 5 Test the Door Contact by opening and closing the door or window when the Control Panel is in "Walk Test" mode. The LED will flash every time the door is opened or closed.
  - Step 6 Remove the Cover assembly, put the jumper switch in the normal "Off" position. Screw the Cover assembly back onto its base.
  - Step 7 Installation is now completed.

#### <NOTE>

- ☞ Ensure the jumper is in the normal "Off" position when testing is finished.

## ● **Using the Extension Terminal.**

The Extension Terminal is provided to enhance installation flexibility and to serve a wider range of your needs. The Extension terminal is most useful in the following cases.

- If the Door Contact cannot be mounted on the door frame, you can connect an additional "extension magnet switch" to the "Extension Terminal" and mount the Door Contact remotely.
- More than one window and door can be protected by a Door Contact using the additional magnet and extension magnet switch. The switches must be wired to the auxiliary terminal block as shown:
- Any device with N.C. (Normally Closed) dry contact, such as broken glass detector, Smoke Sensor, gas detector, water leak detector etc, can be connected to the "Extension Terminal" Making the Door Contact served as an "Universal Transmitter".

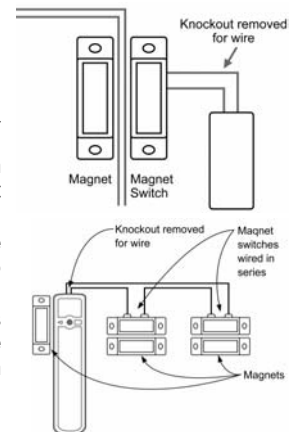

#### <NOTE>

- ☞ The Extension Terminal forms a closed loop with the device connected to it. When the Loop is opened (the device is triggered), the Door Contact is activated.
- ☞ The device connected to the Extension Terminal is in series with the internal magnet Switch. That means both of them can work together at the same time.
- ☞ You have the choice to Use the Extension Terminal alone with the internal magnet switch being bypassed or to use both of them together.

**If you choose to have both of the internal magnet Switch and Extension Terminal work together, then**

- When the protected door is being opened or the external device is triggered, the Door Contact is activated and will transmit a violation signal
- However The Door contact will transmit a "Door Closed" or "Restored Signal" only after the protected door and the violated device being restored.